

XD20/26III

The 3rd generation of Ø20/26 model equipped with powerful back tool unit (Y2)

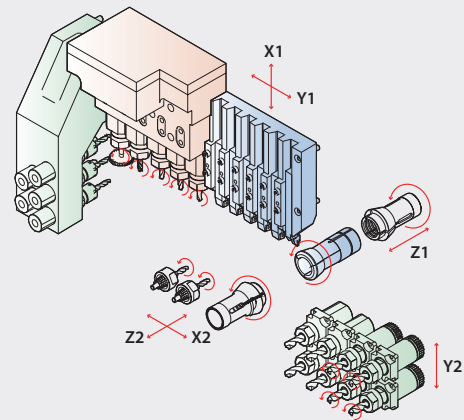

Model		XD20/26III
		NH
NC		Hanwha Fancu i / Siemens 828D
Max. machining diameter (mm)		Ø20/26
Z1 Stroke (mm)		H : 240, N : 60 (Ø20), 80 (Ø26)
Main spindle	Speed (rpm)	10,000 (Ø20), 8,000 (Ø26)
	Motor (kW)	Fanuc : 2.2/3.7 (Ø20), 2.2/5.5 (Ø26) Siemens : 16
OD tool	No. of tools	6 (□12mm) (Ø20), 5 (□16mm) (Ø26)
Front tool	No. of tools	5 (ER16M, Ø25)
Cross drill	No. of tools	5 (ER16) (Ø20), 5 (ER16M) (Ø26)
	Speed (rpm)	6,000
	Motor (kW)	1.0 (Fanuc), 1.02 (Siemens)
Off-center drill (Option)	No. of tools	2 (ER16)
Sub spindle	Speed (rpm)	8,000
	Motor (kW)	1.5/2.2 (Fanuc) , 2.59 (Siemens)
Back tool	No. of tools	8 (ER16) (4 fixed + 4 driven)
	Speed (rpm)	8,000
	Motor (kW)	1.0 (Fanuc), 1.02 (Siemens)
Machine size (L x W x H) (mm)		2,460 x 1,290 x 1,750
Weight (kg)		3,000
Power consumption (Cable size)		6.9kVA, 5.5kW (VCTF 10SQ x 4C)
Air flow rate (Liter/Min)		120 ~ 150

ADVANTAGES

- Optimized & flexible machining for both long and short workpiece with convertible guide bush unit as standard.
- Extended stroke of Z1 240mm with guide bush.

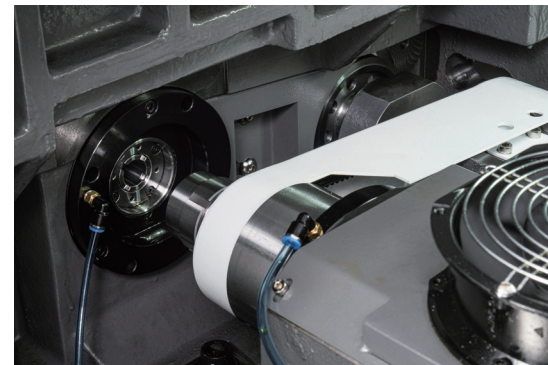

Dimension

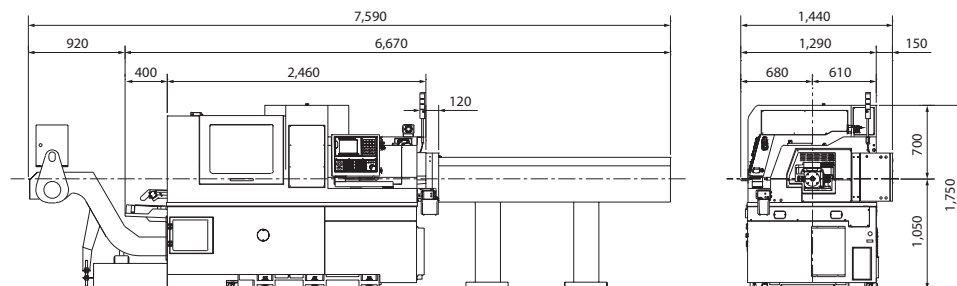

Enhanced Machining Performance

Upgraded structure and specification with various options

Cross Drilling / Milling Unit

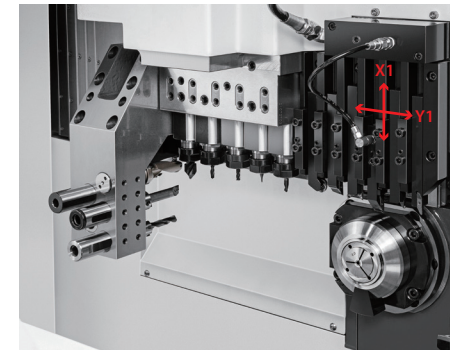

- Improved cross machining performance with increased tool amount of cross
- Powerful cutting available with enhanced power of motor as an option

Standard Specification

- 5 cross drills (ER16)
- Motor power : 1.0kW (Fanuc), 1.02kW (Siemens)
- The same modular with XD20/26II

Option Specification

- Powerful cross motor
- 5 cross drills (ER16)
- Motor power : 2.2kW (Fanuc)
- The same modular with XD20/26II

Back Tool Unit

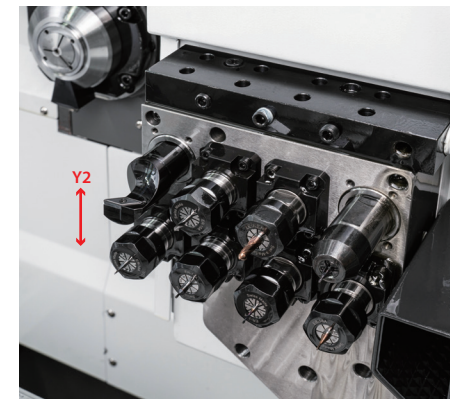

- Y2-axis 8 back tool / Y2-axis back tool cross

Standard Specification

- 8 back tools
- 4 driven / 4 fixed (ER16)
- Motor power : 1.0kW (Fanuc), 1.02kW (Siemens)
- The same modular with XD20/26II
- Gear driven modular

Option Specification

- Back tool cross
- 6 back tools / 2 cross (ER16) / 3 turning (□12) (Ø20) or 2 turning (□16) (Ø26)
- Motor power : 1.0kW (Fanuc), 1.02kW (Siemens)
- The same modular with XD20/26II
- Gear driven modular

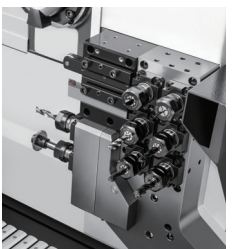

Sub spindle & Off-center Unit



- Spindle motor type of sub spindle with off-center drill

Option Specification

- 2 off-center drill (ER16)
- Motor power : 1.5/2.2kW (Fanuc), 16kW (Siemens)
- Gear driven of one body type

Standard

- Main-Sub Cs control (0.001°)
- Rotary Guide bush holder
- Cross drilling · milling unit (5, Gear modular type)
- MPG
- Part conveyor
- Door interlock
- Coolant flow sensor
- Work light
- Signal lamp (3color)
- LAN port
- Tool monitoring function
- Cut off tool breakage detector (S/W)
- Auto power off
- Bar feeder interface

Option

- Bar feeder
- Chip conveyor
- Transformer
- Tap breakage detector
- Pipe type ejection unit
- Off center drill unit (2)
- Middle / High pressure pump
- Oil mist collector
- Oil chiller
- Memory card
- Tooling & Programming
- Internal coolant driven tool (cross, back, off-center)
- 3 Face/counterface driven tool (cross)
- 3 Face/counterface angle driven tool (cross)
- Extended coolant tank
- NC warranty for 2 years