

XE20/26

5-axis model with reliable performance for
max. dia. 20/26mm

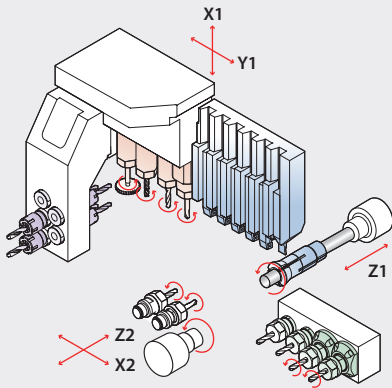

Model		XE20/26				
		H	N	NH	J	Ne
NC		Hanwha Fanuc-i				
Max. machining diameter (mm)		Ø20/26				
Z1 Stroke (mm)		210	60	160 (H), 50 (N)	210	60
Main spindle	Speed (rpm)	10,000 (Ø20), 8,000 (Ø26)				
	Motor (kW)	2.2/3.7 (Ø20), 2.2/5.5 (Ø26)				
OD tool	No. of tools	6 (□12mm) (Ø20), 5 (□16mm) (Ø26)				
Front tool	No. of tools	5 (ER16M, Ø25)				
Cross drill	No. of tools	4 (ER16)				
	Speed (rpm)	6,000				
	Motor (kW)	1.0				
Off-center drill (Option)	No. of tools	2 (ER16)				
Sub spindle	Speed (rpm)	8,000				
	Motor (kW)	1.5/2.2				
Back tool	No. of tools	4 (ER16) (2 Fixed + 2 Driven)		4 (ER16) (4 Fixed)		
	Speed (rpm)	6,000		-		
	Motor (kW)	1.0		-		
Machine size (L x W x H) (mm)		2,260 x 1,240 x 1,670				
Weight (kg)		2,500				
Power consumption (Cable size)		6.9kVA, 5.5kW (VCTF 10SQ x 4C)				
Air flow rate (Liter/Min)		120 ~ 150				

* H : G/B & Driven back tool(2), J : G/B & Fixed back tool

* N : Non-G/B & Driven back tool(2), Ne : Non-G/B & Fixed back tool, NH : Convertible G/B & Driven back tool(2)

OPTION TOOLING

Cross unit 5

- OD 5 (□16)
- Cross 5 (ER16M)
- Front 3 (ER16M)

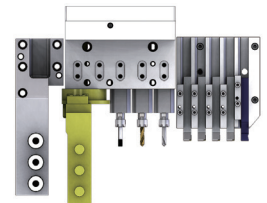

Cross unit 6

- OD 6 (□16 x 1 + □11 x 5)
- Cross 6 (ER11M x 2, ER16 x 4)

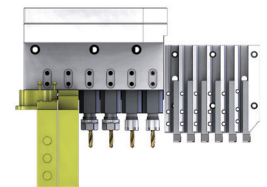

※ Option : 3 Face/counterface driven tool,
3 Face/counterface angle driven tool

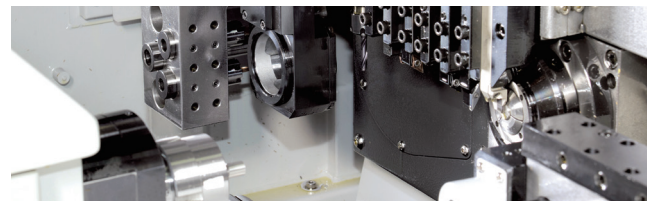

Dimension

