

XE35

5-axis model with reliable performance for max. dia. 35mm

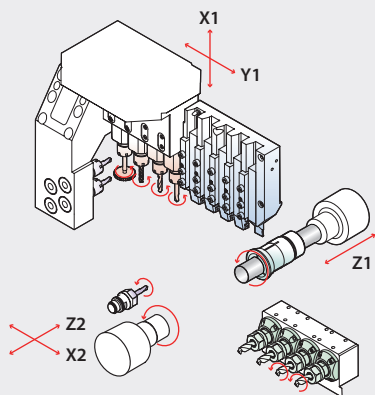

Model	XE35			
	H	N	J	Ne
NC	Hanwha Fanuc-i			
Max. machining diameter (mm)	Ø35			
Z1 Stroke (mm)	210	60	210	60
Main spindle	Speed (rpm)	6,500		
	Motor (kW)	2.2/5.5		
OD tool	No. of tools	5 (□16mm)		
Front tool	No. of tools	4 (ER16M, Ø25)		
Cross drill	No. of tools	4 (ER16M)		
	Speed (rpm)	6,000		
	Motor (kW)	1.0		
Off-center drill (Option)	No. of tools	1 (ER16)		
Sub spindle	Speed (rpm)	6,500		
	Motor (kW)	1.5/2.2		
Back tool	No. of tools	4 (ER16) (2 Fixed + 2 Driven)	4 (ER16) (4 Fixed)	
	Speed (rpm)	6,000	-	
	Motor (kW)	1.0	-	
Machine size (L x W x H) (mm)	2,050 x 1,490 x 1,760			
Weight (kg)	2,750			
Power consumption (Cable size)	6.9kVA, 5.5kW (VCTF 10SQ x 4C)			
Air flow rate (Liter/Min)	120 ~ 150			

OPTION TOOLING

Cross unit 5

- OD 5 (□12)
- Cross 5 (ER16M)
- Front 5 (ER16M)

※ Cross(standard): Spline modular type
 ※ Option : 3 Face/counterface driven tool,
 3 Face/counterface angle driven tool

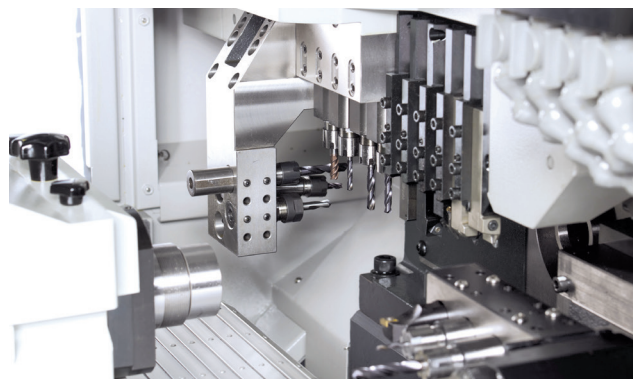
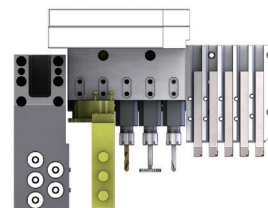

* H : G/B & Driven back tool(2), J : G/B & Fixed back tool
 * N : Non-G/B & Driven back tool(2), Ne : Non-G/B & Fixed back tool

Dimension

