

XP20/26/32S

Compact, in-budget 4-axis model for max. dia. 20/26/32mm
(with side cross tool)

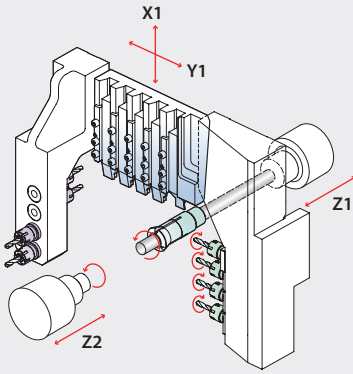

Model	XP20S	XP26S	XP32S
NC	Hanwha Fanuc-i		
Max. machining diameter (mm)	Ø20	Ø26	Ø32
Z1 Stroke (mm)	210	205	
Main spindle	Speed (rpm)	8,000	
	Motor (kW)	2.2/3.7	5.5/7.5
OD tool	No. of tools	6 (□12mm)	5 (□16mm)
Front tool	No. of tools	4 (ER16M, Ø25)	
Cross drill	No. of tools	4 (ER16M)	
	Speed (rpm)	6,000	5,000
	Motor (kW)	1.0	
Sub spindle	Speed (rpm)	8,000	
	Motor (kW)	0.55/1.1	1.5/2.2
Machine size (L x W x H) (mm)	2,030 x 1,140 x 1,710		
Weight (kg)	2,300	2,500	
Power consumption (Cable size)	4.7kVA, 3.7kW (VCTF 10SQ x 4C)	9.5kVA, 7.6kW (VCTF 16SQ x 4C)	
Air flow rate (Liter/Min)	120 ~ 150		

OPTION TOOLING

Cross unit 4 (1 modular)

- ER16M x 4
- ※ Standard cross : Non-modular

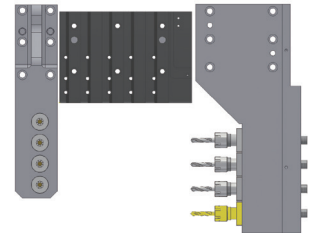

- Right choice for old cam lathe users who need better precision and productivity
- Steady selling model with proven performance & quality

Dimension

